

# BRISTAN

TAPS & SHOWERS

## Installation Instructions & User Guide

Please leave these instructions with the end user

Product code: OP WMNT12 C (D1)

### Specifications

Dynamic Water Pressure

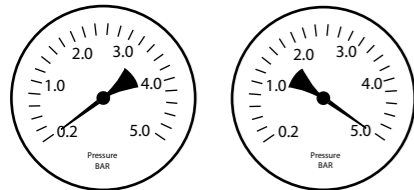

Min: 0.2 bar Max: 5.0 bar

Maximum Static Pressure: 10.0 bar

### Tools You'll need



Flat head screwdriver

Adjustable spanner

Adjustable spanner

### Inlet Connections

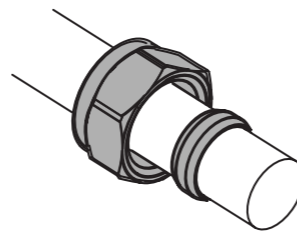

1/2" Compression

### Prior to Installation

All products manufactured and supplied by Bristan are safe provided they are installed, used correctly and receive regular maintenance in accordance with these instructions

Isolation valves **must** be fitted to the inlet water supplies to ensure ease of future maintenance.

This valve allows safe flushing of the tap or shower to avoid installation debris to clog up the mechanical areas of the valve.

This product **must** not be modified in any way as this will invalidate the guarantee.

Full access must be made available for future maintenance / servicing purposes.

This product needs to be installed in accordance with, and meet the requirements of the Water Supply (Water Fittings) Regulations 1999 and Scottish Byelaws 2004.

If in doubt, contact a registered plumber or your Local Water Authority or the Secretary of the Institute of Plumbing, address as follows:-

The Institute of Plumbing,  
64 Station Lane,  
Hornchurch,  
Essex,  
RM12 6NB, Tel: 01708 472791

### Pack Contents

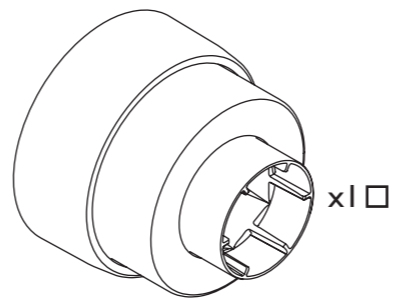
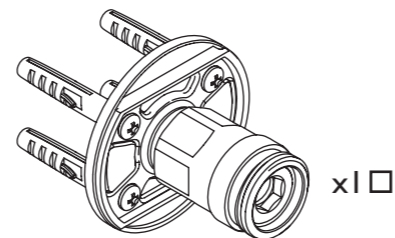

### Why not visit our Youtube channel

To see our latest how-to videos, simply scan the QR code with your smart phone or tablet.



Alternatively visit [www.youtube.com/bristanTV](http://www.youtube.com/bristanTV)

## Installation

1

Identify the required position of the valve and prepare the water supply pipes. Supply pipes should be 150mm apart.

Using the rubber fixing plate, mark the holes to be drilled.

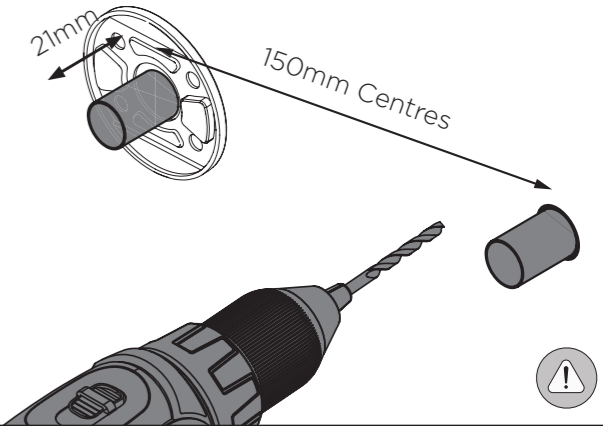

2

Secure the rubber backplate and backplate into place.

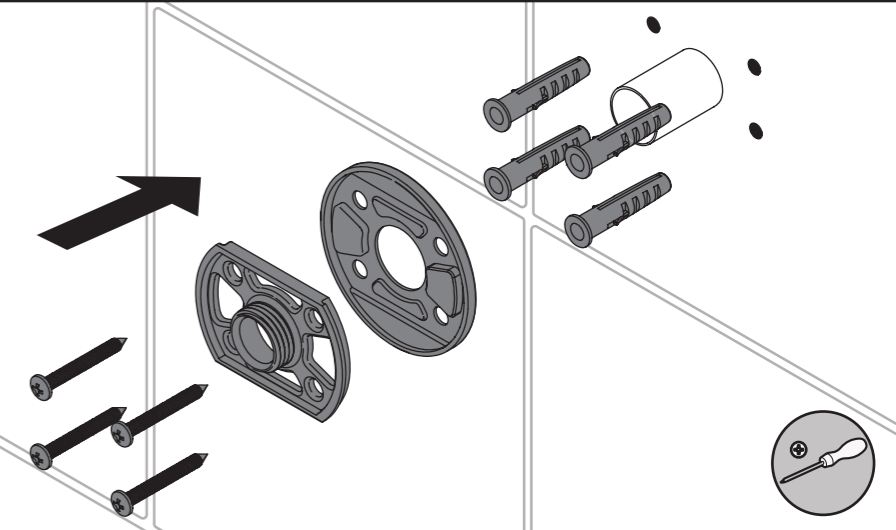

3

Secure the isolator onto the backplate ensuring the olive is positioned over the pipework correctly.

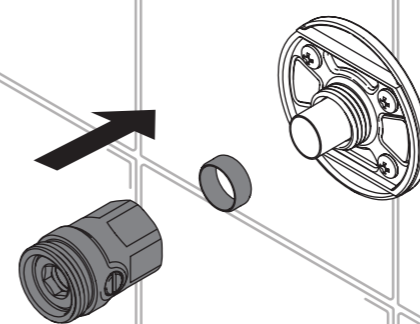

4

Push shrouds to the back of the wall outlet, securing them against the rubber fixing plate

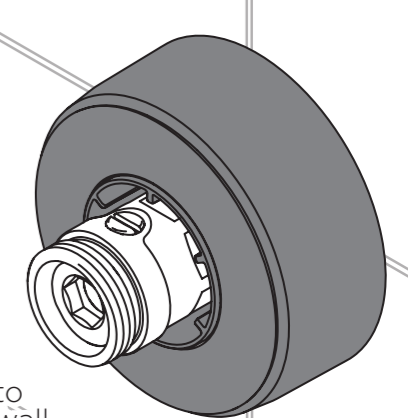

REMEMBER  
To service  
your  
product!



Secure the shower to the wall mount.

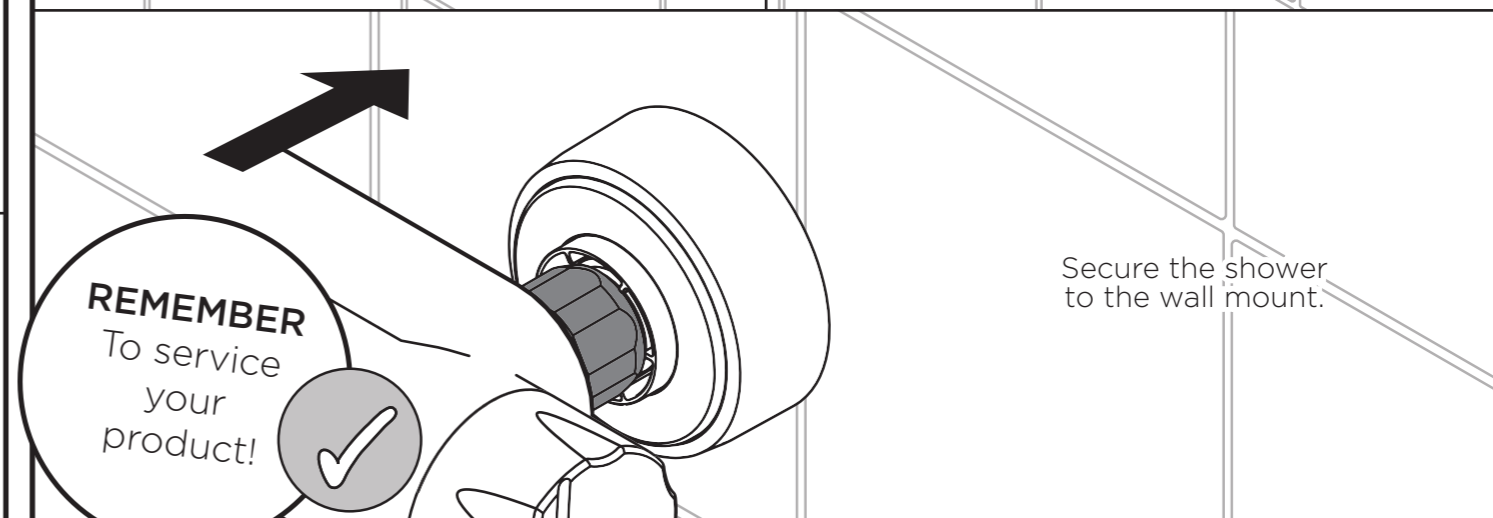

### Isolation

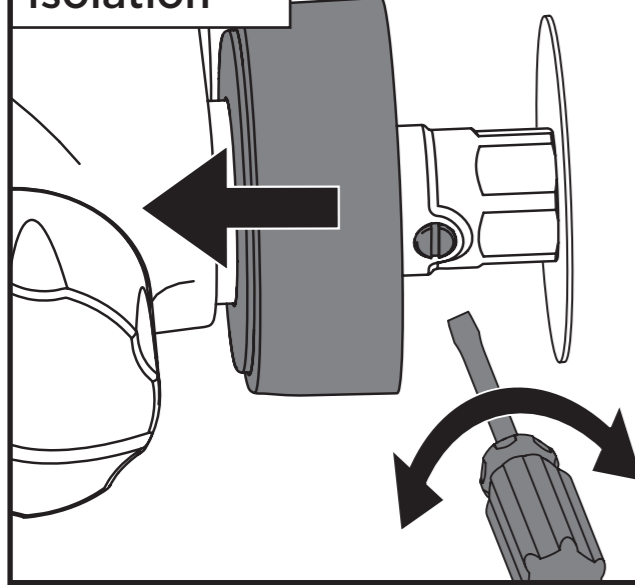

To Isolate the valve, pull the shroud forwards to access the isolator.

Once finished, push the shrouds back into place.



### Notes

At Bristan, we want to make things as easy as possible for our customers. That's why we offer solid guarantees on all our products, effective from the date of purchase, to give you peace of mind.

To start your free guarantee simply scan the QR code and register your product. Alternatively visit [www.bristan.com/register](http://www.bristan.com/register).

For any other queries, please call our Customer Service on 0330 026 6273 where our expert team of advisors will be able to offer you any help and advice.

For full guarantee terms and conditions visit [www.bristan.com/guarantees](http://www.bristan.com/guarantees).

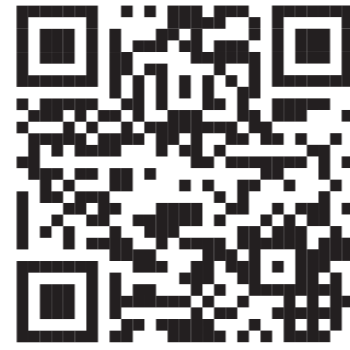

### Spare Parts

To replace any spare parts for your shower why not scan the below QR Code and search for your product.



### Servicing Intervals

To reduce the build up of limescale and to ensure this shower works to its maximum performance we recommend this shower is serviced every 6-12 months depending on the hardness of your water.